

Mechanical Connectors

ME & ME(T) Series - Mechanical Earth Bonding Kits for LV PILC/SWA cables

Application

Mechanical connector kits for the bonding of LV cable armouring and lead sheaths to earth and neutral. Ideally suited for PILC/SWA cables. Lead wipes are not required. Quick and easy to install. All the necessary components are provided in the kit including torque controlled worm drive clamps.

The profiled copper alloy saddle mounts firmly on the lead sheath via the tinned copper mesh providing a solid and reliable bond. The saddle also provides a torque controlled bolted connection to a neutral or earth via a suitably sized copper cable (not included).

The cable armouring, if present, is also bonded to the lead sheath using tinned copper mesh and torque controlled worm drive clamps.

ME Series

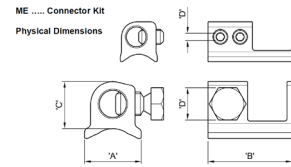

ME(T) Series

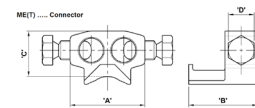
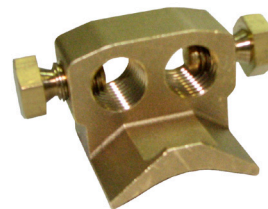

Typical kit contents

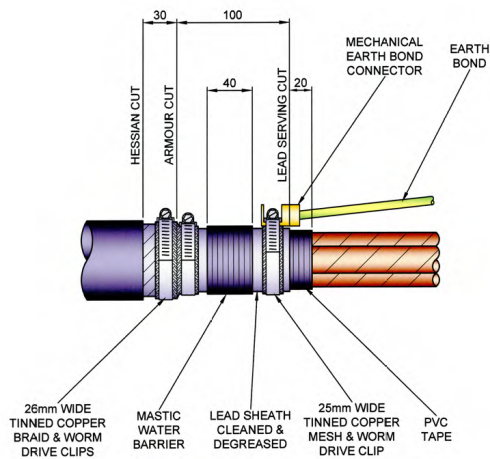

Product Number	Nominal diameter range over lead sheath (mm ²)	Nominal PILC Cable Size range (mm ²)	Nominal PILC Cable Size range (in ²)	Earth bond cable size (mm ²)
ME35	23-32	16-35	0.0225 - 0.06	1 x 10-35
ME(T)35	23-32	16-35	0.02 - 0.06	2 x 10-35
ME50	21-44	25-50	0.04 - 0.08	1 x 10-70
ME120	21-44	25-120	0.04 - 0.2	1 x 10-70
ME(T)120	21-44	25-120	0.04 - 0.2	2 x 10-70
ME185	19-70	150-185	0.25 - 0.3	1 x 10-70
ME400	25-76	150-400	0.25 - 0.5	1 x 10-70
ME(T)400	25-76	150-400	0.25 - 0.5	2 x 10-70

Mechanical Connectors

NE Series - Earth Connectors

Application

For the connection of stranded copper neutral earth conductors in wavecon service and mains distribution cables.

Material

Copper alloy

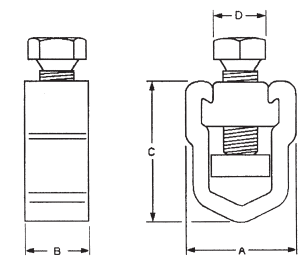
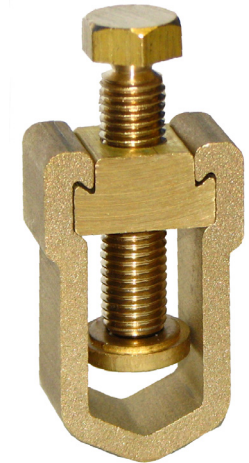

Product Number	Service/Mains Conductor Size Range (mm ²)	Dimensions (mm)			
		A	B	C	D
NE13	25 - 150	28.5	16	36	13
NE15	40 - 240	28.5	16	46	13

NET Series - Earth Connectors

Application

The connection of consac cable (aluminium sheath) to waveform cable neutral earth wires. Suitable for either stranded copper or stranded aluminium neutral/earth conductors of CNE (waveform) cable.

Material

CZ121 Copper Alloy to BS2874

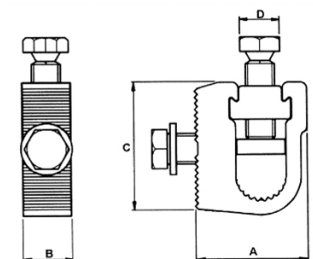
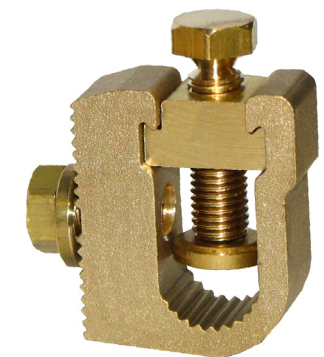

Product Number	Service/Mains Conductor* Size Range (mm ²)	Dimensions (mm)			
		A	B	C	D
NET/1	40 - 240	37	16	44	13

*Suitable for class 1 & 2 copper and aluminium conductors (AS1125) only. Not suitable for flexible cables.